

## INSTRUCTION MANUAL



### WARNING!

Adults should inflate each chamber in numbered sequence (if marked) slowly, using a foot or manually operated air pump. Make sure the device is firm to the touch but not hard.

### CAUTION:



1. THIS IS NOT A LIFESAVING DEVICE.



2. DO NOT OVER-INFLATE.



3. READ THE MANUAL BEFORE USING.



4. DO NOT DIVE OR JUMP.



5. DO NOT SWIM UNDER THE PRODUCT.



6. SHOULD BE ONLY USED BY AGES 14 YEARS AND OLDER.



7. FILL WITH COLD AIR ONLY.



8. DO NOT JERK ON VALVE STEMS.



## INFLATION INSTRUCTIONS:

1. For best results, inflate using a low-pressure air pump.
2. Do not overinflate. Do not attempt to remove every wrinkle from the inflatable.
3. Where there are multiple sections, inflate slowly to allow air to seep into smaller sections.
4. With this box you will have the swim ring plus 1 ball. The swim ring has two parts that need to be inflated: One is at the back rest, the second is at the swim ring. For the ball it has only single valve to inflate. Please find the relevant parts of the valve. Before inflating check whether the valve is damaged. Then fill the right amount of air.
  - Check that the valve is closed before use. Pinch the valve at the base with fingers and insert the plug into the valve opening.
  - After inflating, cover the valve opening with a finger. Then, quickly insert the plug fully into the valve opening, until the head of the plug touches the valve opening.
5. Press closed valve into inflatable so that it is flat with the surface.

**CAUTION:** Do not inflate with an air compressor or any high pressure hose at filling station.

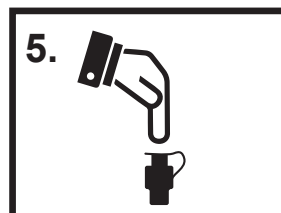
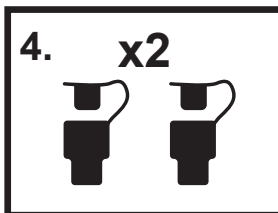
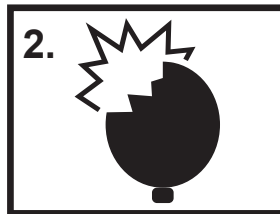



### Speed Valve

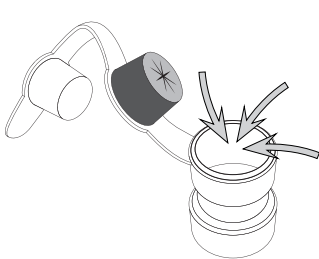

**Fast Inflation**  
Valves fully open for easy inflation with pump or hairdryer etc.



**Inflate by Pump**  
The middle black valve stops the air coming out.

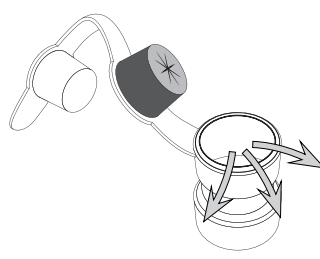

**Fast Deflation**  
Valves fully open for effortless deflation.

### Steps to inflate



Hair dryer with Paper

OR



Hair dryer with plastic bottle

=



Fill with cool air by hairdryer

### Do's and Don'ts

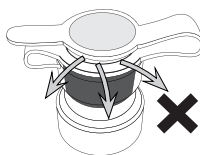
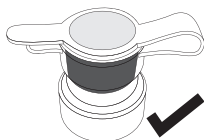
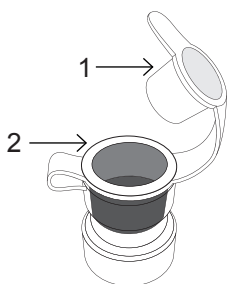

To prevent any leakage, please ensure that "1" is securely and tightly fitted to "2".

Inflate with valves fully open, then close black valve for a full. Avoid over-inflation by filling to 90% - 95% capacity, especially on hot days.

### DEVICES TO INFLATE



HAIR DRYER ON COOL



ELECTRIC PUMP



HAND PUMP



## **MAINTENANCE, DEFLATION, AND STORAGE:**

1. Do not drag over sharp objects or surfaces.
2. Avoid contact with hot or sharp objects.
3. To clean, rinse in lukewarm water and air dry.
4. Only use water and mild soap to clean the article instead of any strong detergents.
5. The inflatable must be kept at room temperature before it is inflated. Extreme temperature can result in a temperature shock, and the inflatable can become defective.
6. Only store the product when it is dry, clean, and not inflated, in a room with a moderate temperature.
7. Make sure the valves are closed before storing the product.

## **REPAIRS:**

The product can be damaged with small holes. If so, you can repair it using glue or a small PVC piece supplied in the repair kit. Please note that the product can be repaired only when deflated. If you use glue, please make sure it is well solidified before inflating again.

## **REPAIR PATCH INSTRUCTIONS:**

1. Locate the leak place and deflate the air.
2. Clean the area surrounding the leakage and wipe up all water from the surface.
3. Take out the repair patch, cut it into the required shape and size, which should be a little larger than the leaking area. Put the patch on the leaking area and press firmly.

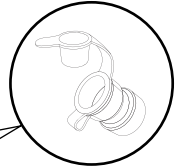
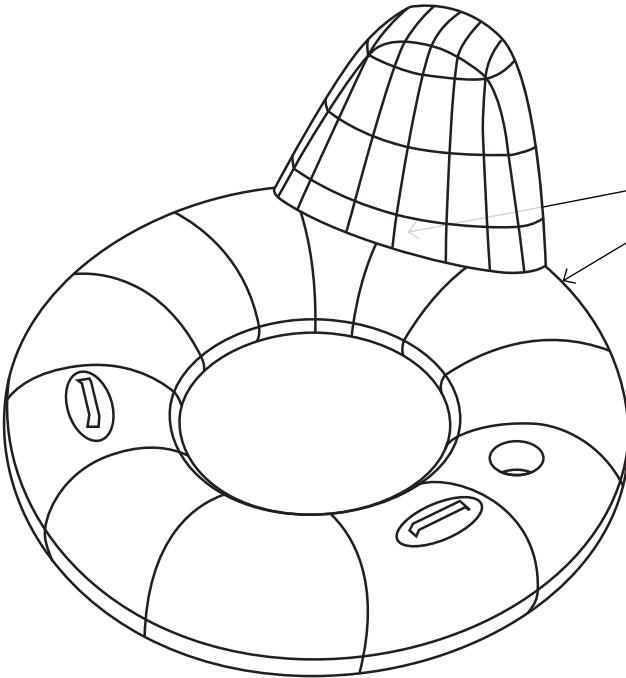

Valve Locations

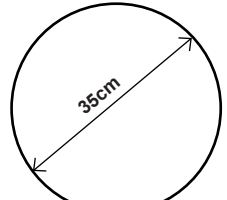

Beach Ball Size

**Hug it!**

**Enjoy it!**

**Love it!**

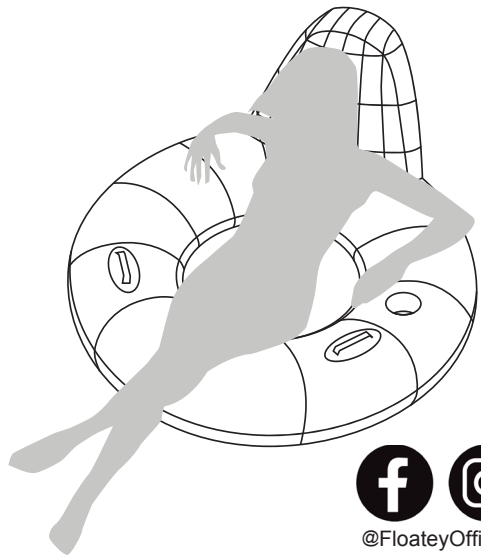

@FloateyOfficial

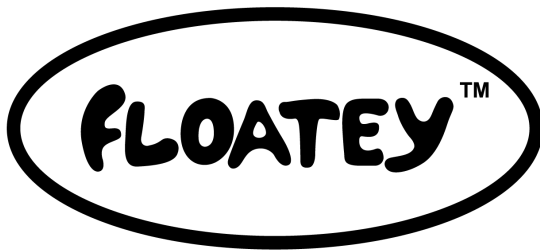

**FOR MORE INSTRUCTIONS**

visit

[www.floatey.com/instructions](http://www.floatey.com/instructions)

Follow, Like & Share



@FloateyOfficial